

# H F C<sup>®</sup> t u r n

Hydraulisches Schnellwechselsystem  
Hydraulic Quick Change System





# HFC<sup>®</sup>turn

Hydraulisches Schnellwechselsystem

## Profitieren Sie von diesen Vorteilen und Eigenschaften

- Easy Handling im Vergleich zu herkömmlichen Spannzangenhaltern
- Mehr Präzision, längere Lebensdauer – dank weniger Vibrationen
- Top Zugänglichkeit selbst in kleinsten Räumen
- Spannflächen 4 x 90°



# HFC<sup>®</sup>turn

Hydraulic Quick Change System

## Benefit from these advantages and features

- Easy handling compared to conventional collet holders
- More precision, longer lifetime – thanks to less vibration
- Top accessibility even in the smallest spaces
- Clamping surfaces 4 x 90°



# HFC®turn - Hydraulisches Schnellwechselsystem

HFC®turn - Hydraulic Quick Change System

## Spannung rückseitig Clamping backside

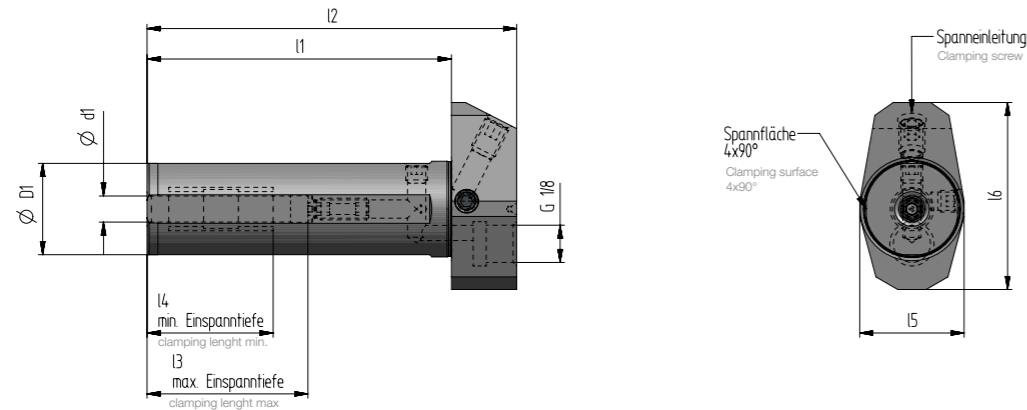

Artikelnummer <small>Article number</small>	Bestellnummer <small>Order number</small>	D1	d1	I1	I2	I3	I4	I5	I6	Lager <small>Stock</small>
S00003240	HD-8X50-D16B	Ø16	8	50	65	20	15	22	37	○
S00003295	HD-3X70-D19.05B	Ø19,05	3	70	85	20	15	22	37	○
S00003296	HD-4X70-D19.05B	Ø19,05	4	70	85	20	15	22	37	○
S00003297	HD-6X70-D19.05B	Ø19,05	6	70	85	37	27	22	39,5	○
S00003242	HD-12X70-D19.05B	Ø19,05	12	70	85	47	37	26	49	●
S00003283	HD-12X100-D19.05B	Ø19,05	12	100	115	47	37	26	49	●
S00003298	HD-3X70-D20B	Ø20	3	70	85	20	15	22	37	○
S00003299	HD-4X70-D20B	Ø20	4	70	85	20	15	22	37	○
S00003300	HD-6X70-D20B	Ø20	6	70	85	37	27	22	39,5	○
S00003241	HD-12X70-D20B	Ø20	12	70	85	47	37	26	49	○
S00003301	HD-3X70-D22B	Ø22	3	70	85	20	15	24	37	○
S00003302	HD-4X70-D22B	Ø22	4	70	85	20	15	24	37	○
S00002835	HD-6X70-D22B	Ø22	6	70	85	37	27	24	43	●
S00003243	HD-12X70-D22B	Ø22	12	70	85	47	37	28	49	●
S00003303	HD-3X70-D25B	Ø25	3	70	85	20	15	28	37	○
S00003304	HD-4X70-D25B	Ø25	4	70	85	20	15	28	37	○
S00003305	HD-6X70-D25B	Ø25	6	70	85	37	27	28	43	○
S00003244	HD-12X100-D25B	Ø25	12	100	115	47	37	28	49	●
S00003306	HD-3X70-D25.4B	Ø25,4	3	70	85	20	15	28	37	○
S00003307	HD-4X70-D25.4B	Ø25,4	4	70	85	20	15	28	37	○
S00003308	HD-6X70-D25.4B	Ø25,4	6	70	85	37	27	28	43	○
S00003245	HD-12X70-D25.4B	Ø25,4	12	70	85	47	37	28	49	●
S00003284	HD-12X100-D25.4B	Ø25,4	12	100	115	47	37	28	49	●

weitere Abmessungen auf Anfrage other dimensions on request

# Reduzierhülsen

Reduction sleeves

## Spann-ø 12mm Clamping diameter 12 mm

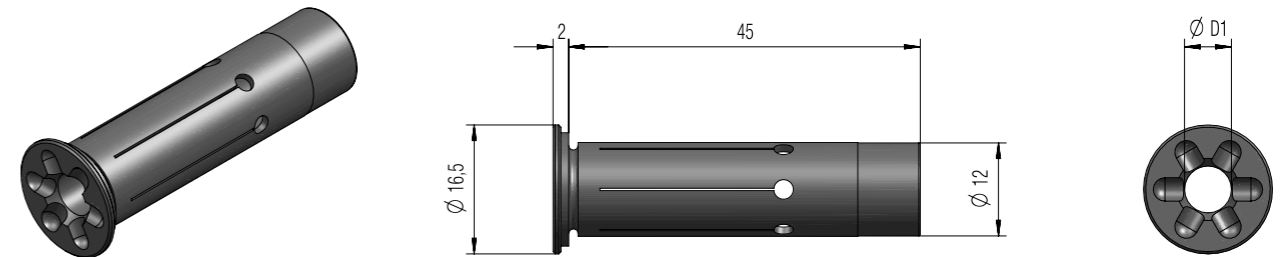

GEDICHTET <small>Sealed</small>		
Bestellnummer <small>Order number</small>	D1	Lager <small>Stock</small>
RED-MEX12-3-GD	3	●
RED-MEX12-4-GD	4	●
RED-MEX12-5-GD	5	●
RED-MEX12-6-GD	6	●
RED-MEX12-8-GD	8	●

NICHT GEDICHTET <small>Not Sealed</small>		
Bestellnummer <small>Order number</small>	D1	Lager <small>Stock</small>
RED-MEX12-3-KM	3	●
RED-MEX12-4-KM	4	●
RED-MEX12-5-KM	5	●
RED-MEX12-6-KM	6	●
RED-MEX12-8-KM	8	●

Hyrodehn für Langdreher  
Hydraulic expansion for Swiss-type Lathes

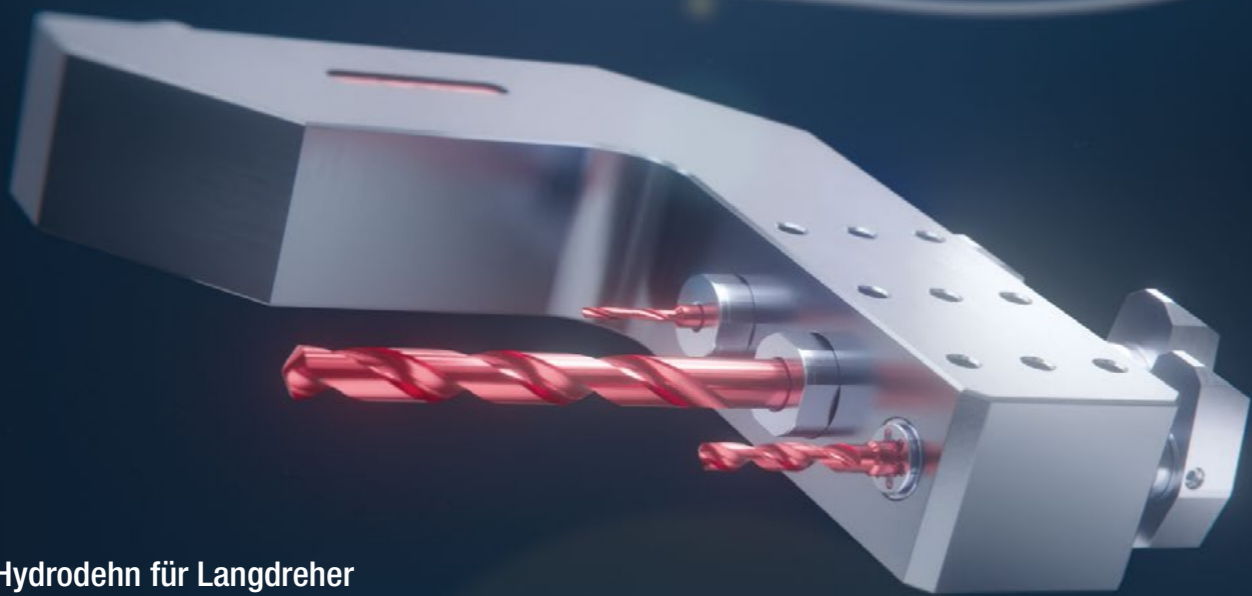

Werkzeugwechsel – einfach, schnell und sicher  
Tool Changes - simple, quick and safe



Top Zugänglichkeit selbst in kleinsten Räumen  
Top Accessibility even in the smallest Rooms

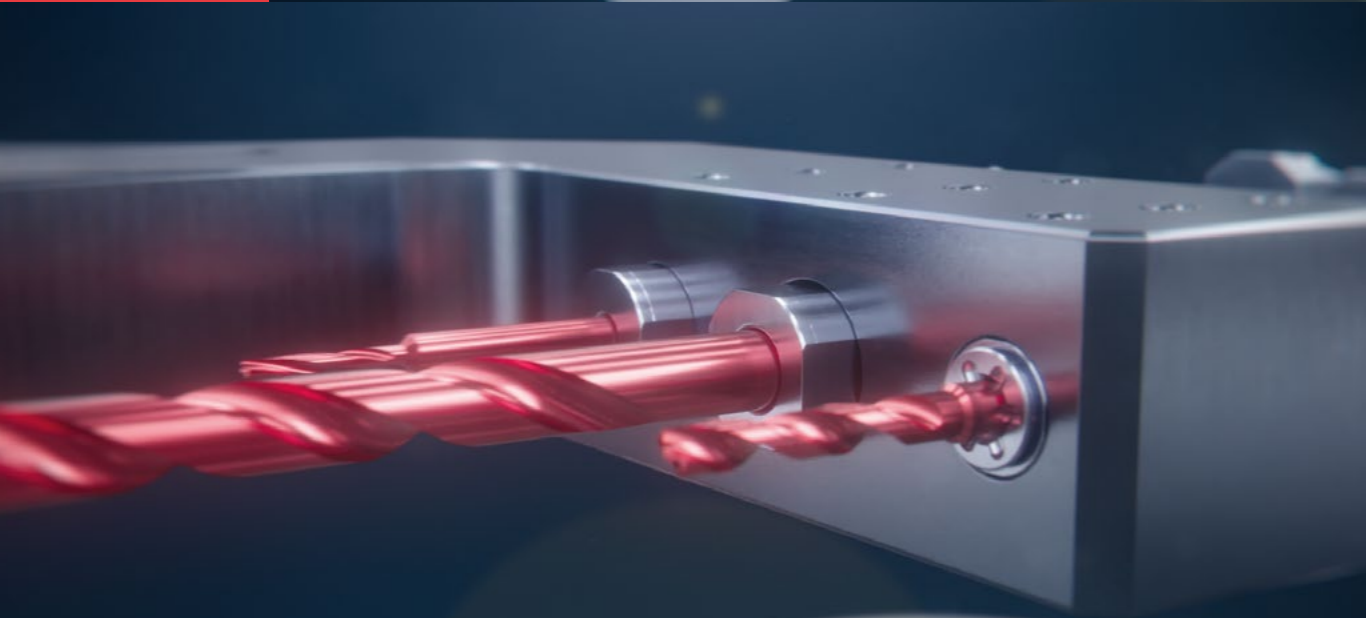

THINK  
OUTSIDE  
THE  
BOX

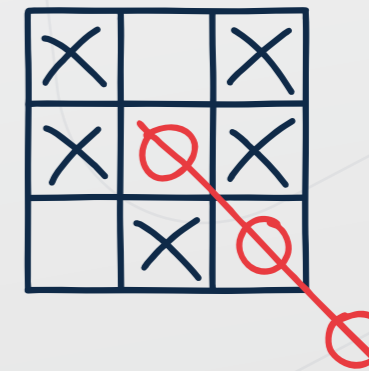

**MAS**  
TOOLS & ENGINEERING

MAS GmbH  
Schmigalla Straße 1  
71229 Leonberg

Tel +49 7152-6065-0  
Fax +49 7152-6065-65

zentrale@mas-tools.de  
www.mas-tools.de

